

# Newnham College Library

## Ground Floor

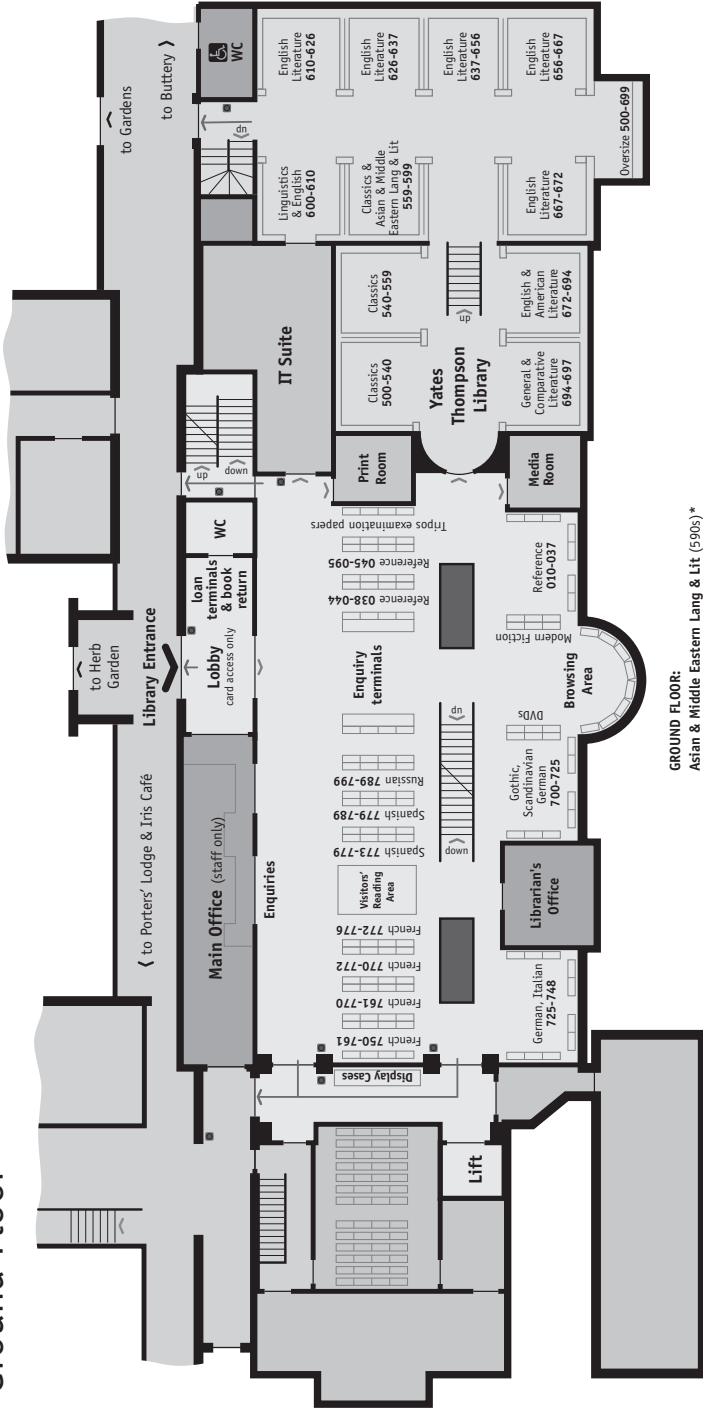

- GROUND FLOOR:**
- Asian & Middle Eastern Lang & Lit (590s)\*
  - Classics (500s)\*
  - Comparative Literature (600s)\*
  - Current Periodicals & Newspapers
  - English Language & Literature (600s)\*
  - Linguistics (600s)\*
  - Modern Languages (700s)
  - Reference (000s)
  - Tripos examination papers
- \* = Yates Thompson Library

- Fire alarm call point
- Fire exit

# Newnham College Library

## First Floor

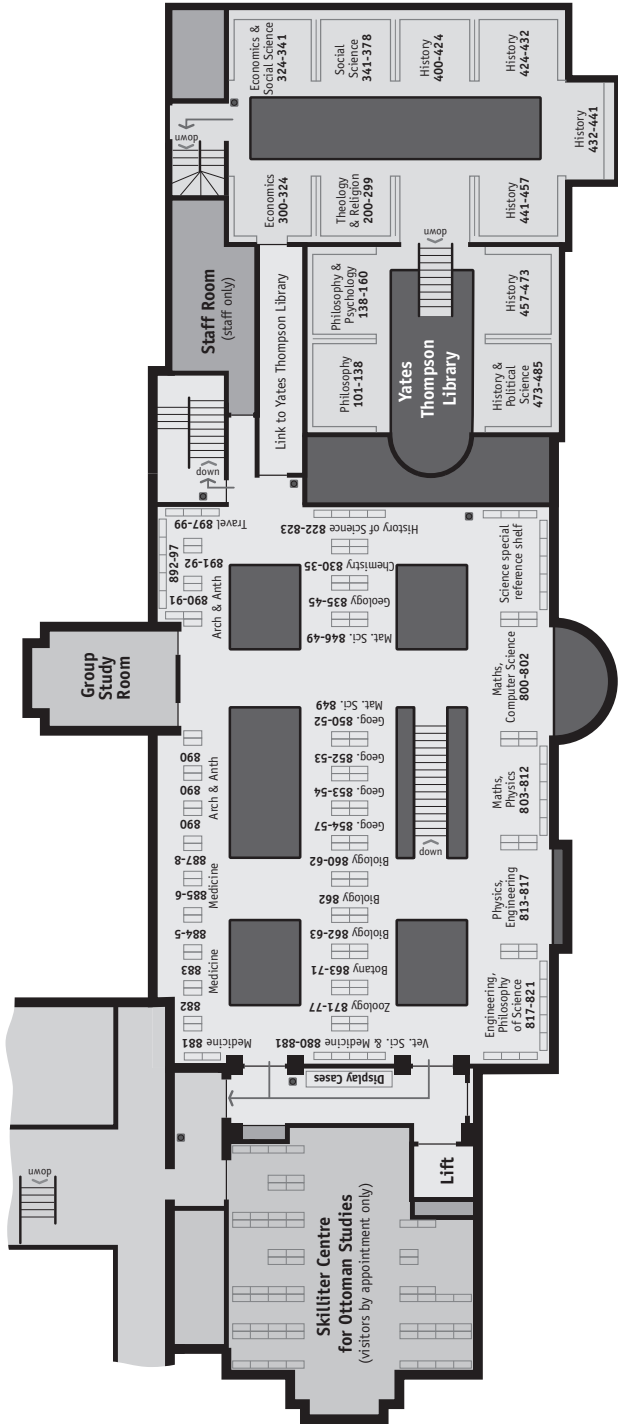

### FIRST FLOOR:

- Archaeology & Anthropology (890s)
- Economics & Social Science (300s)\*
- Geography (850s)
- History (400s)\*
- Philosophy & Psychology (100s)\*
- Political Science (480s)\*
- Science (800s)
- Science special reference shelf
- Theology & Religion (200s)\*

\* = Yates Thompson Library

■ Fire alarm call point

→ Fire exit

# Newnham College Library

## Basement

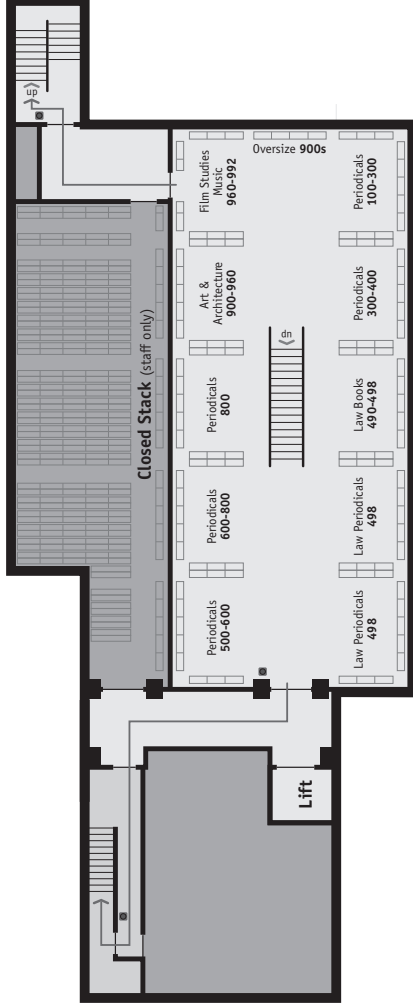

**BASEMENT:**  
Art, Architecture,  
Film Studies & Music (900s)  
Bound periodicals (all subjects)  
Law (490s)

- Fire alarm call point
- Fire exit